

## OM2C LED Based Medium Intensity Obstruction Light

The optical part is based on Fresnel lens, a transformed convex lens which can concentrate light to a small specific angle to meet with ICAO and FAA requirements. Fresnel lens is often used to design obstruction light. High power LED replaces gas-discharging light tube to reach 2000cd light intensity.

The heat is dissipated to the environment by aluminum columns centering in the light. The top aluminum shield and thermal conducting silicone grease is also helpful for dissipation. The light's ingress protection level is IP67, assures the light is well sealed to stand harsh environment include the ocean. If work with control box, more functions like synchronization could be realized. GPS or GPRS functions also available if needed.

Medium intensity light OM2C is for object taller than 45m. It should be used alone. When the top of the object is 45m more than surrounding buildings, additional intermediate level OM2C need to be installed. OM2C complys with ICAO regulation, medium intensity type C, red color, fixed (not flashing)

### Functions & Features

- Unique optical design complys with ICAO & FAA
- Longer lifetime expectancy
- Almost maintenance free
- Lower voltage (than xeon) makes it safer for installer
- Cost effective in long run
- 5 years warranty

### Application

- Telecomm tower
- Radio tower
- Wind turbine
- Somke stacks & chimney

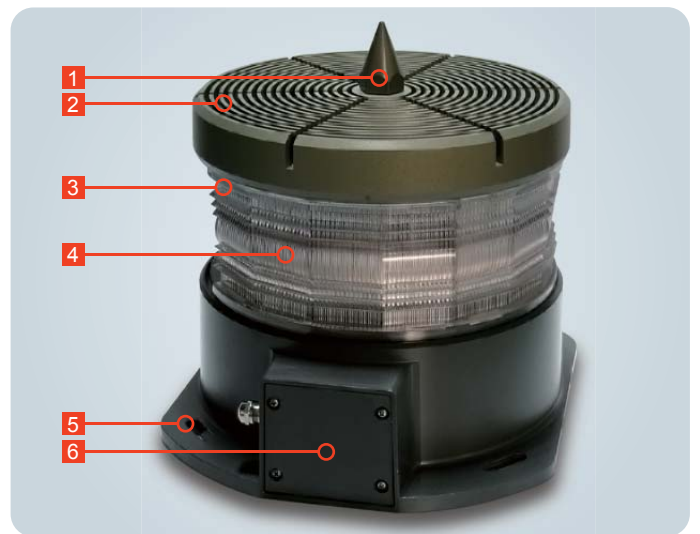

- 1 Bird spike
- 2 Aluminum cover good thermal conductor
- 3 Fresnel lens
- 4 High power LED
- 5 Mounting plate
- 6 Wiring box LNE type



## Specifications

LIGHT OUT-PUT	
Effective Intensity	1900 Candela
Vertical Divergence	-1°1050cd, Centering at 1°
Horizontal out-put	360 Degree
LED Color	Red
LED Lifespan	100,000 Hours
OPERATION	
Flash Pattern	Steady-burning
POWER SUPPLY	
Input voltage	110VAC, 220VAC
Frequency	50Hz ~ 60Hz
Power consumption	90W
MECHANICAL STRUCTURE	
Lens	Polycarbonate, UV Stabilize
Body	Die-casting Aluminum
Water-proof	IP67
Weight	9.5 KG
Temperature Range	-40 C ~ +55 C
Relative humidity	100% with condensation
Dimensions	300mm H, 330mm Diameter
Warranty	5 years
Optional	Available with built-in photo sensor

## Product Standard

ICAO Annex 14, 4th Edition, July 2004

## Classification under Standard

ICAO medium intensity, type C

## Packaging

440 x 440 x 390(mm), Carton

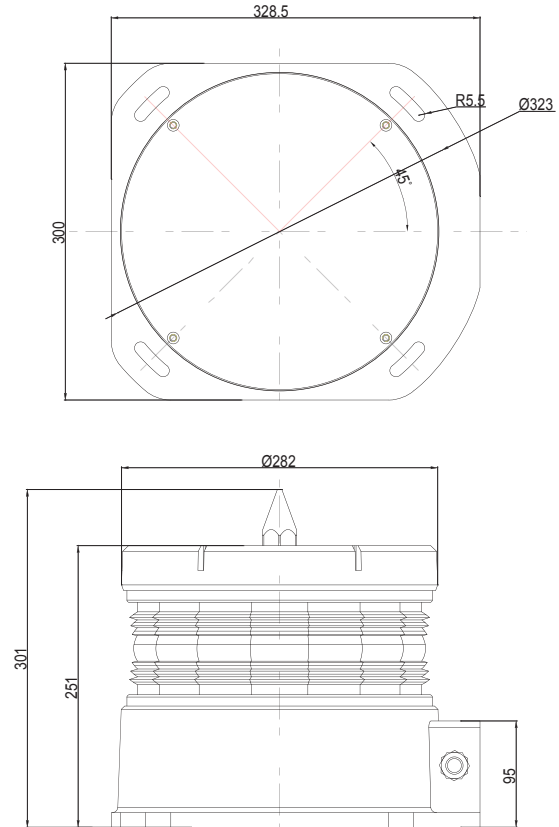

## OM2C Series Photometric Performance

